

BACKFLUSH

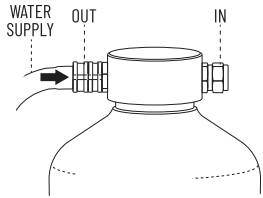

Backflush the unit every 3 months for 3 to 5 minutes.

- 1 Connect the water source to the outlet port on the tank cap/head.
- 2 Turn the water on with high flow for high pressure and faster washing.

WATER HARDNESS TEST

Use the included water hardness test strip for the following:

- To check the water quality of the water source
- To check the quality of the water output from the portable RV water softener from time to time. If the water is hard, regeneration is needed.

WATER HARDNESS TABLE

Classification	Grain Per Gallon (GPG)	Parts Per Million (PPM)
Soft	0 to 3	0 to 60
Slightly hard	3 to 7	61 to 120
Hard	7 to 11	121 to 180
Very hard	>11	>181

REGENERATION

- Disconnect the hoses connected to the unit.
- Remove the cap/head.
- Fill the tank with 2 x 26 oz table salt.
- Return the cap/head.
- Reconnect the water source to the inlet port on the tank cap/head.
- Flush the unit for 30 minutes by turning on the water slowly until the water is flowing 90° to the ground or drain. Note: The water contains a high amount of salt, DO NOT drain on grass/flowers/trees.
- Increase the water flow for 10 minutes until the salt is fully dissolved.
- The unit is ready for use if the saltwater is completely drained from the unit.

Note: If a backflush is needed at the time of the regeneration, make sure to backflush first before regeneration.

DRAINING

Turn the unit upside down and allow water to drain from both inlet and outlet ports. DO NOT remove the cap/head while draining.

STORAGE

- Backflush the unit.
- Regenerate the unit.
- Drain the unit. Make sure the unit is dry.
- Store the unit away from direct sunlight.

RE-USING AFTER STORAGE

- Backflush the unit.
- Regenerate the unit.
- Sterilize the tank before use or every year.

TROUBLESHOOTING

- | | | |
|---|---|---|
| i. There's a leak on the cap/head
- Twist and tighten the cap/head properly.
- Replace the o-ring. | ii. There's a leak on the inlet/outlet
- Make sure that the fittings are properly connected. Add a PTFE thread seal tape if needed. | iii. Doesn't soften water
- Check the quality of the water using the included test strip. If the water is hard, regeneration is needed. |
|---|---|---|

FAQ

Q: What kind of salt is to be used?
A: Regular table salt

Q: Can this be used for spotless rinse for car washes?
A: Yes, but you still need to dry your car with a cloth after washing

NP GLOBAL PORTABLE WATER SOFTENER

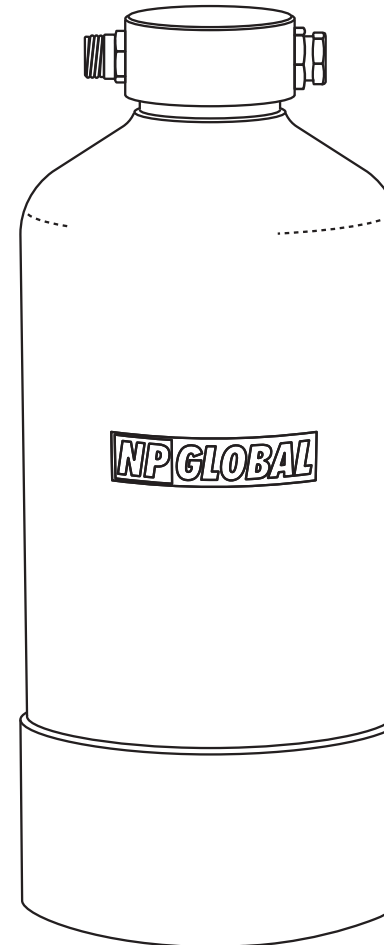

FEATURES

- 16,000 grains
- 3/4" GHT fittings
- NSF Certified food-grade premium resin
- Handle included for easy carrying
- Fiberglass wrap
- Weather-resistant neoprene fabric cloth cover
- Sturdy vessel with base
- Easy setup
- Ready for use in 4 to 6 minutes
- Provides 40% more soft water
- Regenerates in 30 to 40 minutes
- Limited lifetime warranty

BENEFITS

- Softens hard water and removes stain
- Increase the lifespan of the appliances
- Improves rough and dry skin
- Improves water taste and odor
- Anti-scale build-up
- Increase soap lather
- Reduces calcium, magnesium, iron, lead, radium and other heavy metals

APPLICATIONS

- RV/Trailer
- Marine/Boats
- Spa
- Mobile car washing
- Pressure washers



- VIDEO TUTORIALS
- WARRANTY ACTIVATION

Visit our website to find more

WWW.WATER-SOFTENER.INFO

NEED SUPPORT? Call or Text

+1 (888) 421-3737

Available from 8 am to 5 pm EST Monday to Friday



INCLUSION

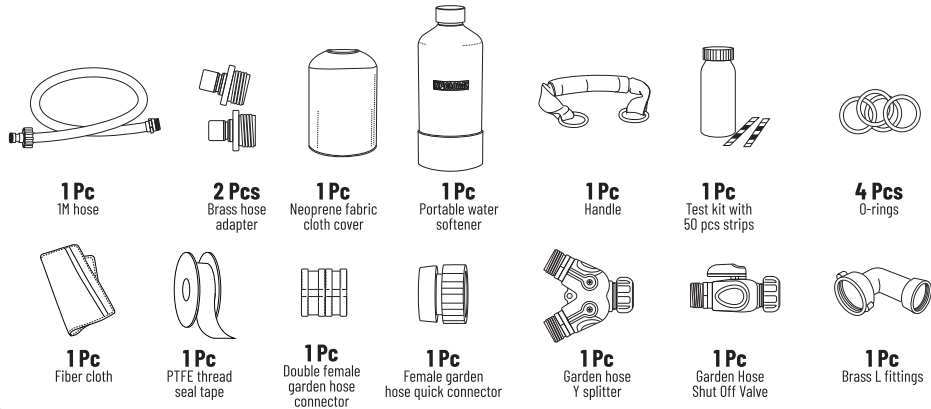

TECHNICAL PARAMETERS

i. Model	: RV-16000	v. Inlet water valve	: 3/4" GHT fittings
ii. Grains	: 16,000	vi. Salt for regeneration	: 2 x 26 oz table salt
iii. Capacity	: 650 to 16,000 gallons	vii. Life span	: 8 to 10 years
iv. Resin	: NSF Certified food-grade premium resin	viii. Regeneration & flush	: 30 minutes to regenerate & another 10 minutes to flush

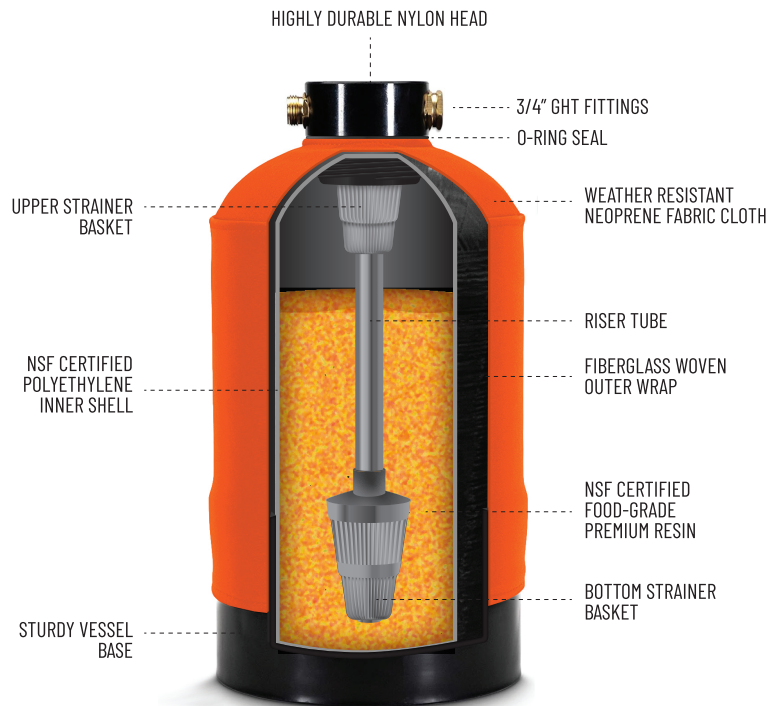

DIMENSION

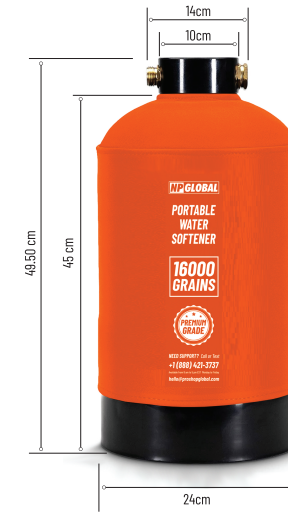

PRE-FLUSH

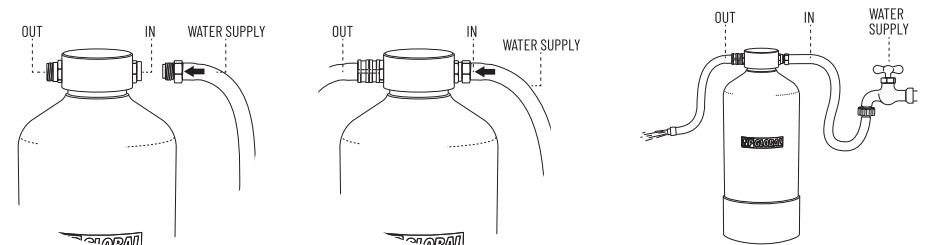

- 1 Connect the water source to the inlet port on the tank cap/head.
- 2 Connect a hose to the outlet port on the tank cap/head. A double female garden hose connector is included if needed.
- 3 Turn the water on and flush the unit for 4 to 6 minutes. While flushing, you might notice a discoloration in the water, this is normal because the resin is new and will release particles on the initial flush. After 4 to 6 minutes, the water should be clear and ready for use.

HOW TO SET UP

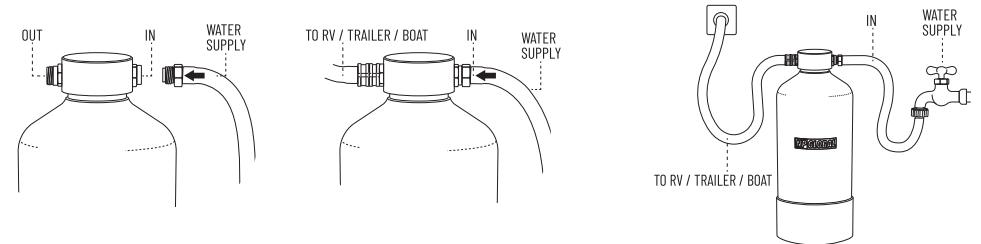

- 1 Connect the water source to the inlet port on the tank cap/head.
- 2 Connect a hose to the outlet port on the tank cap/head. A double female garden hose connector is included if needed.
- 3 Connect the other end of the hose to the inlet port of your RV/trailer/boat.

Note: Make sure that the unit is secure with a sturdy strap in your vehicle while traveling. Make sure that the unit is placed on a flat surface, upright and level, and never install on its side.